

WHEN DO I GET MY RURAL ADDRESS SIGN? DO I HAVE TO PAY FOR MY RURAL ADDRESS SIGN?

- Project commenced in the Summer of 2012 with a completion date of 2013; if you have not received your sign by fall of 2013 please contact the County.
- Any permanent structure intended for residential or business use in place before October 1, 2012 will be eligible to receive a sign at no cost.
- New developments after October 1, 2012 will be required to pay a fee for the installed sign as part of the development permit process. Signs will be installed by the County once your building is complete.

WHAT IF I DON'T WANT A RURAL ADDRESS SIGN?

- As per Bylaw #2012/06, all residential & commercial properties require a rural address sign. Rural address signs are an effective tool to help reduce response times in emergency situations by helping Emergency Services pinpoint the access to the property off a range road or township road in the County of Wetaskiwin.

Rural addressing has been assigned to all County of Wetaskiwin Residential & Commercial Properties. Ratepayers will find their new rural address (Municipal Address) on their 2013 Tax Notices or on the online County map that is now available on the County website at www.county.wetaskiwin.ab.ca (Just click on the Online Services link)

Rural Addressing FAQ

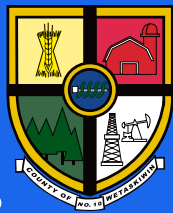

For more information please contact the County Office:

**County of Wetaskiwin No. 10
Box 6960 Wetaskiwin, AB T9A 2G5**

Telephone: (780) 352-3321 Toll Free #:1 (800) 661-4125

Edmonton Direct: (780) 429-0198 Fax: (780) 352-3486

HOW DO I KNOW WHAT MY RURAL ADDRESS IS?

- Your rural address is located on your tax notice under Municipal Address
- County of Wetaskiwin Digital Map found at www.county.wetaskiwin.ab.ca
- Your rural address is a combination of your township road, interval & range road

Example:



460

Township Road

011

Interval 11 in 40 meter grid. Odd number indicates access on the east side of Range Road 71 north of Township Road 460.

A

A = 1st Residence on property

B

B = 2nd Residence on property

Rge RD 71

The driveway is located along Range Road 71

WHEN CAN I START USING MY RURAL ADDRESS? WHAT DO I USE IT FOR?

- You can start using your rural address as soon as your sign has been installed.
- Your rural address is meant to be used for an "Emergency Address" (Ambulance, Fire & RCMP).
- In case of an emergency dial 911 and provide them with your Rural Address.
- Your rural address is **NOT** your mailing address unless notified by Canada Post. Most Courier companies do require your rural address to deliver your packages (UPS, Purolator, Federal Express, etc)

WHY IS MY SIGN INSTALLED WHERE IT IS?

- As per Bylaw #2012/06 Schedule B Part 2 (Sign Placement), the Rural Address sign is installed in the County road right of way on the right hand side of the approach. It is important that each sign be located in a consistent manner so Emergency Services know where to look.

I DON'T HAVE A RURAL ADDRESS SIGN, HOW DO I GET ONE?

- If you are in the process of building a residence a rural addressing sign will be assigned during the Development permit process.
- If there is no residence on the property there will be no rural address assigned.
- Contact County of Wetaskiwin office for more information.

MY SIGN IS DAMAGED/MISSING, HOW DO I GET A NEW RURAL ADDRESS SIGN?

- The rural address signs will be maintained by the County. Contact the County of Wetaskiwin office to report any damages incurred to signage.



Rural Address Examples

Addresses are based on the location of the primary access along a road allowance. Each mile of road is divided into intervals of 40 metres, with numbers increasing from South to North and East to West. Even numbers are along the North and West sides of a road allowance and odd numbers are along the South and East.

For the purposes of addressing, virtual township roads exist between all sections, whether an actual road allowance exists or not. Forced roads may be built outside the township/range road grid and designated with a letter including the range road or township.

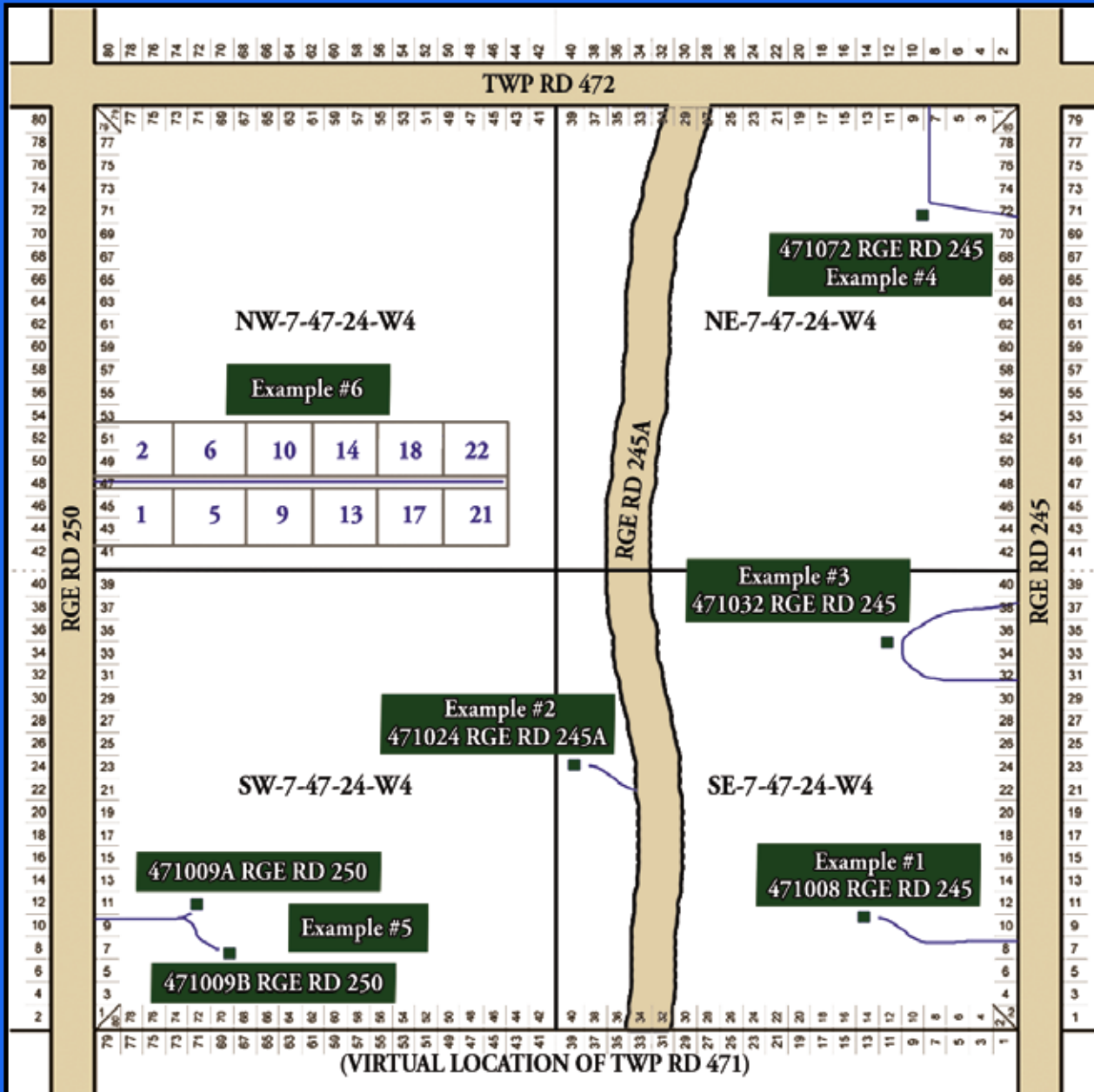

Example #1: 471008 RGE RD 245

The access is along the west side of Rge Rd 245. It's located in address interval 8. 471 is the intersecting Twp Rd number to the south.

Example #2: 471024 RGE RD 245A

When access is off a forced Road (road built outside of the Range Road / Township grid where range road name resignates from the range road to the east) the rural address is assigned using the township road (471), interval (024) and range road name (245A).

Example #3: 471032 RGE RD 245

When there are multiple accesses along the same side of a road allowance the primary access is the access with the lowest interval number.

Example #4: 471072 RGE RD 245

When there is one access along a Twp Rd, one access along a Rge Rd, the primary access will be determined by the County GIS department.

Example #5: 471009A & 471009B RGE RD 250

When there are multiple residences located off the same primary access, the first building off the access is designated "A", the second building is designated "B", and so forth.

Example #6: Rural Subdivision

All subdivisions within the County will be assigned a regular 6 digit rural address at the main entrance to the subdivision. Within the subdivision each parcel will be assigned a unique identifying address in sequential in-crements of 4, with even numbers being on the north and west, and odds being on the south and east. This will make each individual address the unique identifying number followed by the 6 digit rural address.